

NOTE: This home may require wall bracing tie-downs depending on wind/seismic design. Please refer to the permit set for tie-down loads and locations if applicable. Some areas of the exterior wall sheathing may be shipped loose to allow access for tie-down installation. All tie-down designs are by others.

QTY	U/M	DESCRIPTION	CLASS
2	Each Mt	Window, MI 2430	Window
1	Each Mt	Window, MI TR-3009	Window
2	Each Mt	Window, MI 3050	Window
2	Each Mt	Window, (2) MI 3050-2	Window
1	Each Mt	Window, (2) MI 2426w/Arch	Window

Rev 4

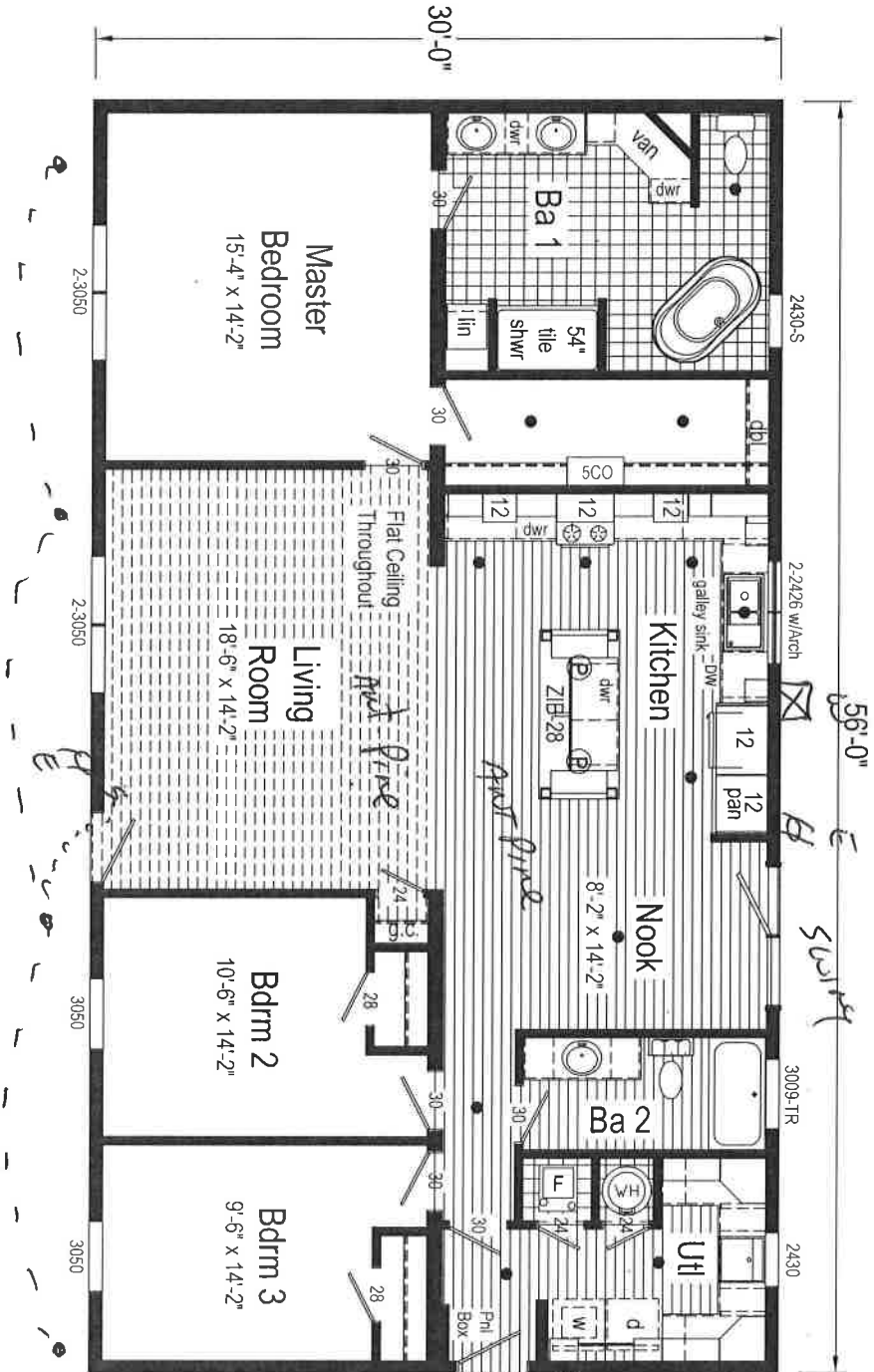

2LM1017-V5 3256 Approx. 1680 Sq. Ft.

Builder:	Commodore Homes of Indiana	Callout:	3256	Revisions:	11/04/2018 B001	Scale:	1/8" = 1'-0"	Date:	10/14/2020	Cust STOCK	Dir. GOEGLEIN HOMES, LLC.	Model/Eng. No.:	2LM1017-V5
Title:	Literature	Drawn By:	BB	Reference:	AM248-A1	SN:	17448	Pg.:	LIT				

Note: Because of varying state requirements and optional equipment, some or all of the utility locations might change per floor plan (ie: furnaces, wh, stairwell). Consult your sales representative for exact specifications.

Stock File  
5385748  
Nas